



HyVibe H2

Quick Start Guide

Welcome HyViber



You are about to embark on a musical journey that will inspire your musical creativity.

This Quick Start Guide will give you the basics of how to get started.

To access the full user guide for the HyVibe System and the HyVibe Mobile app, visit: www.hyvibeuitar.com/downloads

For instructions on how to install the HyVibe System on a guitar, visit www.hyvibeuitar.com/installation-documents

Download the HyVibe Mobile App and create an account here:



The HyVibe Interface



Indicator icons for MIDI pedal, mobile app connection. Fx = effects are turned on.

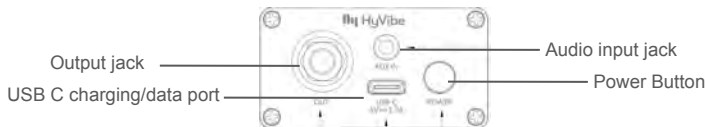
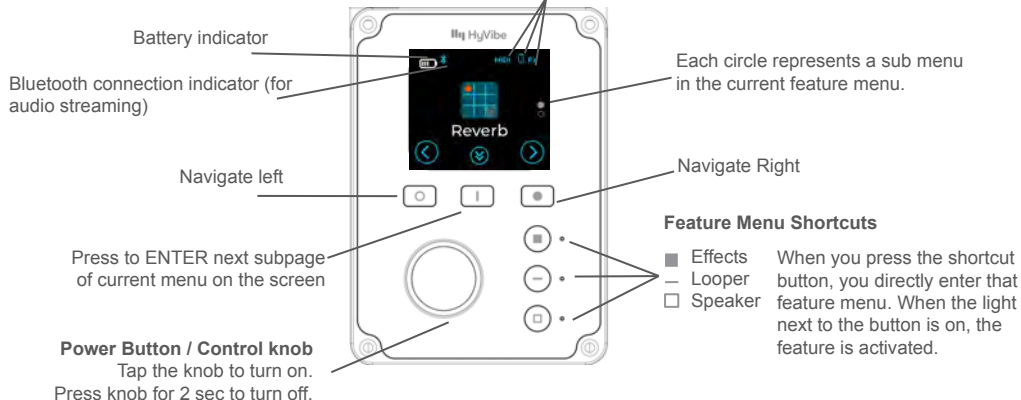

HyVibe Core Features



Play with self-amplified effects.

To turn on the Effects, either press the Effect menu shortcut button , or scroll with the right/left buttons until you reach the Effects menu.

Press the ENTER button to enter the Effects menu and select your effect with the right/left buttons.

To modify the effect, press the ENTER button and adjust the effect parameter with the control knob. You can make further adjustments using the mobile app.

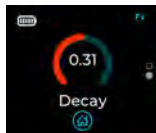

Turn your guitar into a Bluetooth Speaker.

Use your phone standard Bluetooth settings to connect the HyVibe System. When the Bluetooth Icon  appears on your guitar, you are paired and ready to jam with your favorite music and backing tracks.

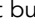
Navigate to the Speaker menu with the shortcut button () or with the right/left arrow keys. Press the ENTER button to turn Speaker mode on (the speaker icon will turn orange).





Let's start looping.

1. Choose the effect you would like to record with in the Effects Menu.
2. Enter the Metronome menu to set the time signature and BPM for your recording. In this menu you can also adjust the volume of the metronome click that you hear when recording a loop.

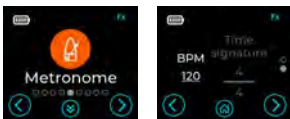

3. Enter the Looper Menu and press the Enter button to access the second screen in the Looper Menu. Choose the 'lead' effect (the effect that will be automatically activated after the loop is recorded) and the number of bars you want to record. When the loop is playing back, you can change the lead effect.

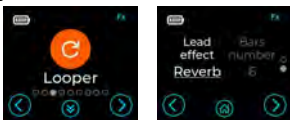

4. To begin recording a loop, press the right button in the main looper menu. A countdown screen will appear. The recording begins after a 1 measure countdown. And you will see a green line going around the circle, indicating that you are recording.





Let's start looping.

5. You can record 3 additional tracks. To add an additional layer, press the record button. A timer icon will appear indicating that the additional loop layer will be recorded during the next loop playback and a countdown will display one measure before the recording begins.



6. To erase the most recent loop layer, hold the right button. A trash icon will appear. Hold for 2 seconds and the last recorded track will be erased. If you release before 2 sec, the action is cancelled.



7. If you press the play button before the programmed loop finishes recording, you enter 'free mode'. You can still add and remove layers, but the screen will display a ring to indicate the approximate position of the playback.



You are now ready to Vibe

For more HyVibe resources, tutorials, and manuals, visit:

www.hyvibeguitar.com

SHARE YOUR CREATIONS WITH #HYVIBE

AND FOLLOW US ON SOCIAL MEDIA:



This device complies with Part 15 of the FCC Rules. Operation is subject to the following two conditions: (1) this device may not cause harmful interference, and (2) this device must accept any interference received, including interference that may cause undesired operation.